

# ZZ\_Electr. Buzzer EM Pulse tone 230VAC B



Part No.: 107.010.68



## MECHANICAL DATA

|                              |                             |
|------------------------------|-----------------------------|
| Height                       | 61 mm                       |
| Diameter                     | 28 mm                       |
| Materials                    | PA-GF                       |
| Housing colour               | Black                       |
| Protection category          | IP65                        |
| Connection                   | Screw terminals             |
| cross-sectional area maximum | 1,50mm <sup>2</sup> / 16AWG |
| Type of fixing               | Built-in mounting           |
| Working temperature minimum  | -20°C                       |
| Working temperature maximum  | +50°C                       |
| Weight with packaging        | 33 g                        |
| Product weight               | 21 g                        |

## ELECTRICAL DATA

|                             |                                |
|-----------------------------|--------------------------------|
| Operating voltage           | 230V                           |
| Operating voltage type      | AC                             |
| Operating voltage frequency | 50Hz                           |
| Operating voltage tolerance | +/- 10%                        |
| Rated operational voltage   | 230 VAC                        |
| Rated operational current   | 8 mA                           |
| Rated inrush current        | 500 mA                         |
| Protection class            | Protection class 2             |
| Pollution degree            | 3<br>In the connection area: 2 |
| Overvoltage category        | II                             |
| Isolation voltage           | Ui = 250V; Uimp = 2.500V       |

## ACOUSTIC DATA

|                               |                 |
|-------------------------------|-----------------|
| Volume (max) at 1m distance   | 60,0 dB (A)     |
| Volume (max) at 10cm distance | 80,0 dB (A)     |
| Acoustic signal image         | Pulse tone      |
| Audio frequency               | 2400 Hz         |
| Acoustic service life         | 5,000 h minimum |

## APPROVAL DATA

|                              |     |
|------------------------------|-----|
| Conforms with CE             | Yes |
| Conforms with RoHS directive | Yes |
| WEEE                         | Yes |
| Conforms with ATEX-directive | No  |



For additional installation and mounting information, refer to the appropriate user guide at [www.werma.com](http://www.werma.com). This printed copy is for information only and is subject to alteration.

## ZZ\_Electr. Buzzer EM Pulse tone 230VAC B

|                           |         |
|---------------------------|---------|
| Conforms with CCC         | No      |
| Conforms with UL          | cULus   |
| UL Type Rating            | Type 4X |
| Conforms with FCC         | No      |
| Conforms with IC          | No      |
| EAC certificate available | Yes     |
| Conforms with AS-I        | No      |
| ICAO Certification        | No      |
| Conforms with DNV         | No      |
| Conforms with RoHS CN     | No      |
| Conforms with VdS         | No      |

### DRAWING

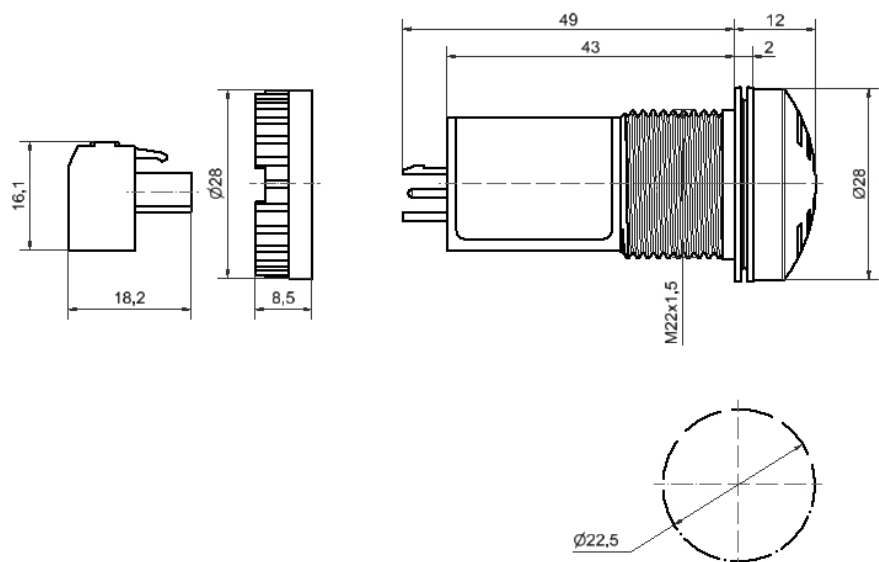

For additional installation and mounting information, refer to the appropriate user guide at [www.werma.com](http://www.werma.com). This printed copy is for information only and is subject to alteration.